



Classic Challenge 2017

**West Lothian and
Linlithgow –
TM, Access, Maps,
and Moto
Arrangements**

10th September 2017

9 May 2017



Contents

List of Appendices 2

IntroductionError! Bookmark not defined.

The Route..... 3

 Improvements for 2017 3

 Blackness Roundabout 3

 Increased Moto Presence..... 3

 Other Changes Considered..... 4

 Linlithgow Bridge..... 4

 B9080 One-Way Closure 4

Communications 5

Appendix..... 1

 Linlithgow Local Access Map 1

 B9080 Local Access Moto Service 2

 Linlithgow Diversion Map..... 3

 West Lothian Local Access Map 4

List of Appendices

Ref	Document Title	Issue	Issue Date	Author
01	Linlithgow Local Access Map	-	09.05.17	WMP
02	B9080 Local Access Moto Service	-	09.05.17	WMP
03	Linlithgow Diversion Map	-	09.05.17	WMP
04	West Lothian Local Access Map	-	09.05.17	WMP

Introduction

Following on from consultations with the local community we were asked to explore ways to reduce the impact the road closures have on access in the area for residents of West Lothian and Linlithgow. We have spoken to councils, Police Scotland, traffic management experts and considered several options for 2017. This document will outline the 2017 event route as well as the additional and improved provisions put in place to help access. Local resident maps are also included to visualise the options. The aim will be to open the roads again as soon as possible in the afternoon.

The Route

The 2017 Pedal for Scotland route travels through West Lothian along the same route as 2016, entering Linlithgow from the west and following the high street through town. It exits the town on the B9080 in an eastbound direction towards Winchburgh (see appendix 1). Roads are closed for a pre-agreed period to allow for the necessary safety infrastructure to be laid on the route and safety stewards and route teams to be deployed along sections of the route ahead of the participants. Roads will be re-opened as soon as it is safe to do so once the last participant has passed through and all obstructions in the road are removed. Pedal for Scotland is Scotland's largest mass participation Cycling event with nearly 10,000 people taking part across three different challenges. These challenges are open to all ages and abilities from as young as five years old. To deliver the event safely for this number of participants it is important that we provide a safe traffic free route.

Improvements for 2017

There are several improvements and changes to the traffic management specifics which will help improve access for Linlithgow residents.

Blackness Roundabout

Residents will be able to access Linlithgow from the A803 on the Blackness Rd to the high street. They will also be able to leave the town from High Port turning right at the Blackness roundabout and onto the Blackness Rd. See appendix 1.

Increased Moto Presence

To provide better access for residents we will be increasing the moto provision along the B9080. 5 motos will operate on two dedicated loops (appendix 2) to help improve the ability to offer access plans to residents (this is more than double the provision in place in 2016).

The B9080 will be closed for the duration of the event. Specific managed access plans will be offered to residents needing to leave at certain times and residents will be allowed to enter the route under moto guidance in an eastbound direction. Residents will be accompanied by motos to turn North on The Park Bistro and the Philipstoun turnings or turn South before Kingscavil or down to Bridgend. These moto

pickups will not need to be pre-booked but residents will have to wait until one of the dedicated moto team picks them up before being allowed onto the route. This will be managed between the stewarding company and the motos. Winchburgh residents will also be offered managed access plans through a moto service.

Other Changes Considered

In the process of finalising and agreeing the route for 2017 several alternative arrangements were considered in detail. The considerations are outlined below to help provide context as to the reasoning behind the 2017 route.

Linlithgow Bridge

Allowing two-way traffic along Linlithgow Bridge was explored. This option would allow cars to enter and leave the town from the A803. To achieve this a 3-phase light set up would be needed.

To test the viability of this layout some traffic light timing was modelled to anticipate the wait times for riders and motorists. The various timings of this set up are detailed below. For each phase the largest "All Red" time must be used. The delay for cyclist and traffic can be calculated as follows:

If a cyclist is just stopped at a red light at the end of the B825 they would have to wait 85 seconds on red while the cyclist who got through on the green light were safely inside the closure on Main St. Then they'd wait for 90 seconds' green and 30 Seconds red for Phase 2 and then 90 seconds' green and 30 seconds' red for Phase 3 = 325 seconds = 5 minutes 25 seconds.

The delays for vehicles would be greater by 30 seconds (5 minutes 55 seconds) due to the additional green time allowed for the (slower moving) cyclists.

Early in the morning before traffic volumes increase it may be possible to use minimum green times which would give a delay of 4 minutes 5 seconds, however conversely latter in the day when traffic volumes increase it may be necessary to increase the green times to the maximum resulting in potential delays of 6 minutes 25 seconds.

As the timings above demonstrate allowing access and egress to vehicles along the A803 in the west end of Linlithgow could cause increased traffic congestion in the town.

B9080 One-Way Closure

One option considered for residents living along the B9080 was a one-way closure. The specifics and challenges of this are detailed below:

- Road to remain fully closed for the duration of the Wee Jaunt Edinburgh start
- After Wee Jaunt Edinburgh riders have cleared the B9080 up to the Park Bistro turn then the road

- to be re-opened in an eastbound direction up to the Park Bistro.
- Riders and vehicles separated by a cone line down the middle of the road with temporary speed limits also imposed on traffic.
 - Riders to use the westbound side of the road but travelling eastbound.
 - Residents on the North side of the B9080 able to turn left towards Winchburgh and then left off the route at the Park Bistro turning.

To implement a one-way closure along the B9080 there would be a significant increase in the length of time before the road was fully re-opened due to the additional traffic management infrastructure put in place. The one-way closure would also not improve access for residents on the south side of the route, as they would still require managed access should they need to travel on the day.

Communications

A focus for 2017 is providing clearer and simpler information for residents this includes detailed diversion maps, local access maps. These are included as an appendix to this document.

We would encourage anyone with priority needs, especially care visits, to get in touch with Pedal for Scotland as soon as possible to allow a managed access plan to be developed.

Appendix

Linlithgow Local Access Map

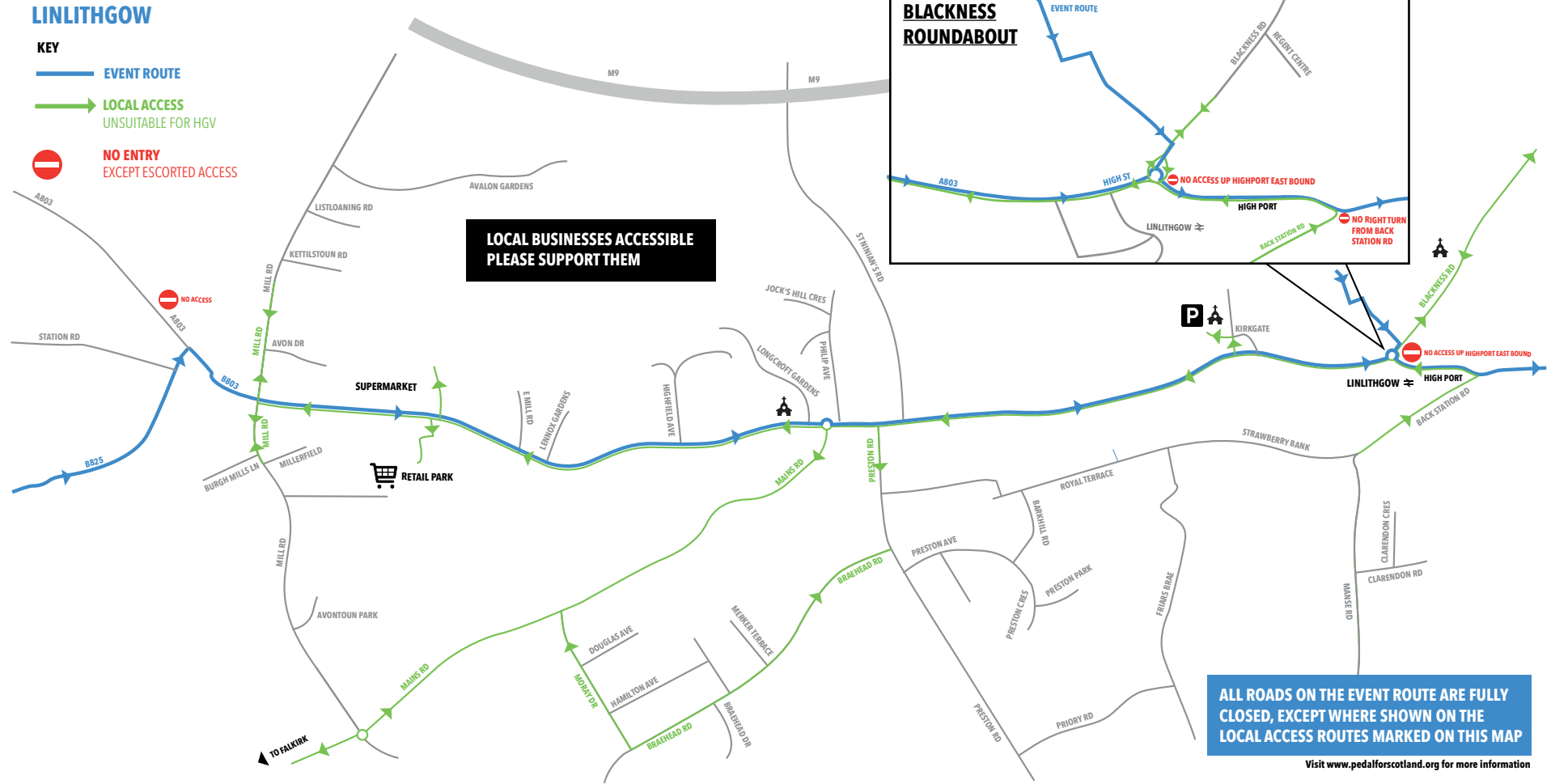



B9080 Local Access Moto Service

B9080 MOTO ACCESS LOOPS

- KEY**
- EVENT ROUTE
 - LOCAL ACCESS
 - MOTO ACCESS ROUTES FOR B9080 RESIDENTS

Visit www.pedalforScotland.org for more information

ALL ROADS ON THE EVENT ROUTE ARE FULLY CLOSED, EXCEPT WHERE SHOWN ON THE LOCAL ACCESS ROUTES MARKED ON THIS MAP

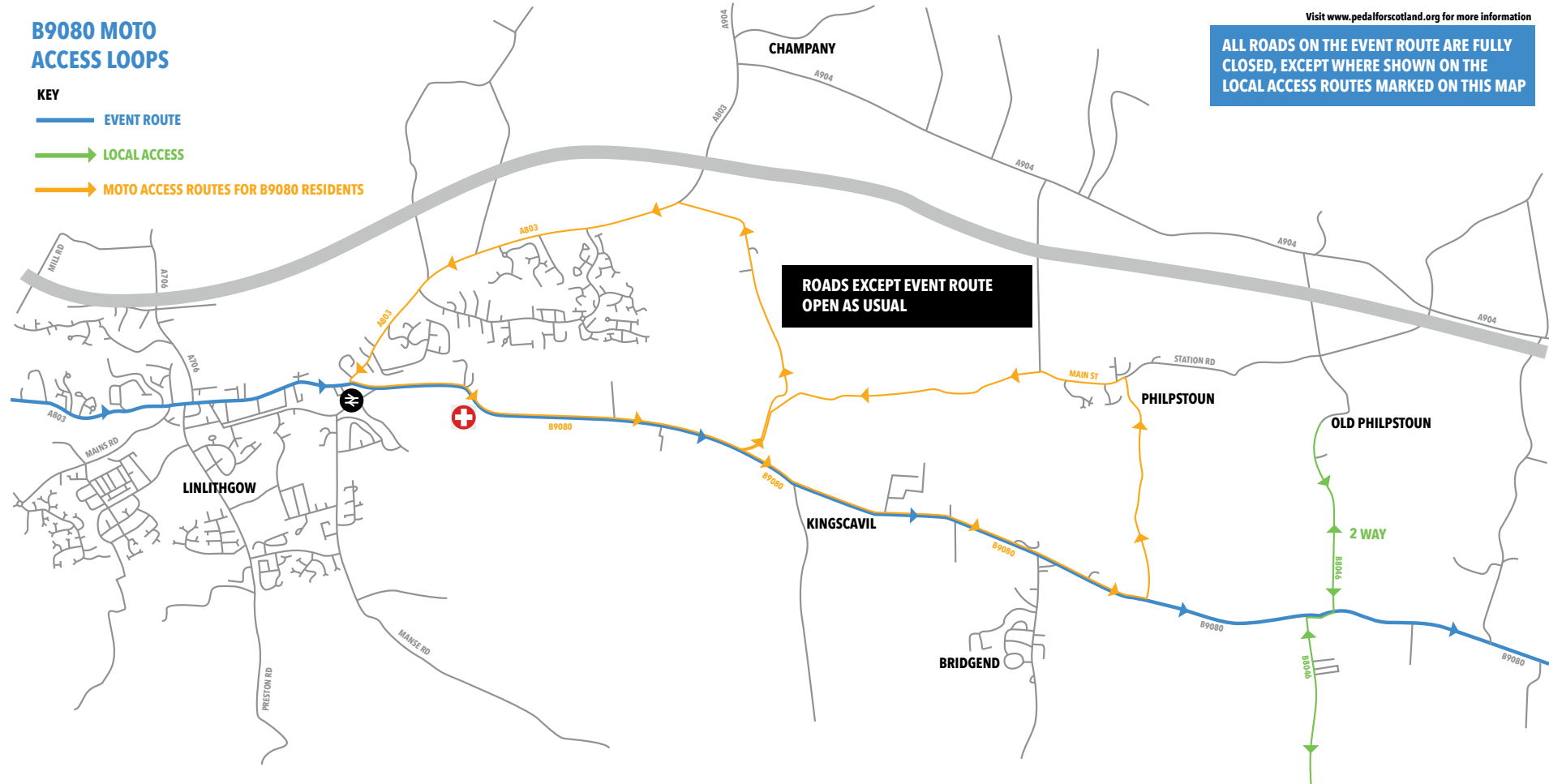

Linlithgow Diversion Map

LINLITHGOW VEHICLE DIVERSIONS

- KEY**
- THE ROUTE
 - LOCAL ACCESS
UNSUITABLE FOR HGV
 - LINLITHGOW BYPASS
ANY VEHICLE
 - NO ENTRY

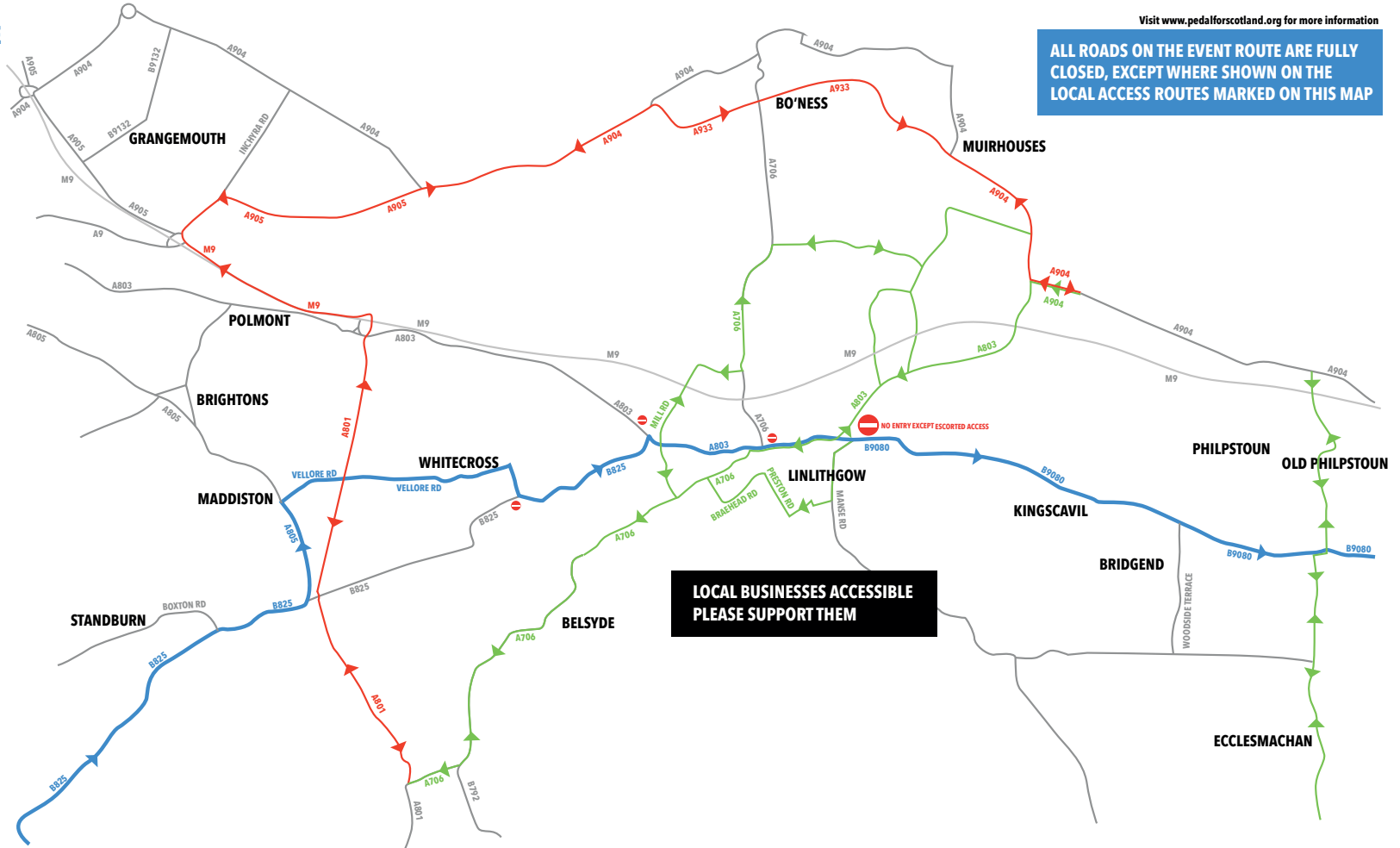

Visit www.pedalforscotland.org for more information

ALL ROADS ON THE EVENT ROUTE ARE FULLY CLOSED, EXCEPT WHERE SHOWN ON THE LOCAL ACCESS ROUTES MARKED ON THIS MAP

LOCAL BUSINESSES ACCESSIBLE PLEASE SUPPORT THEM



West Lothian Local Access Map

Visit www.pedalforscotland.org for more information

ALL ROADS ON THE EVENT ROUTE ARE FULLY CLOSED, EXCEPT WHERE SHOWN ON THE LOCAL ACCESS ROUTES MARKED ON THIS MAP

WEST LOTHIAN

- KEY**
- EVENT ROUTE
- LOCAL ACCESS

